

# SOVOL

## User Manual

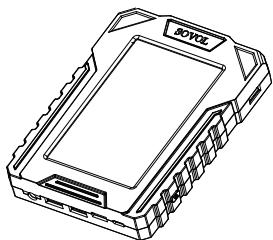

# 5.0 Touchscreen



1 Touchscreen

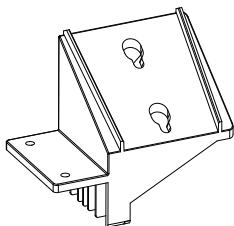

2 Mounting Bracket

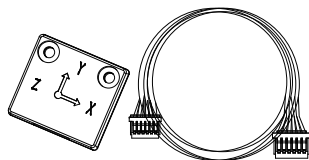

3 Acceleration Sensor Kits

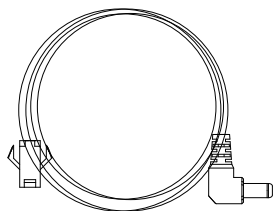

4 DC Power Cable A

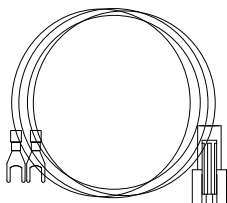

5 DC Power Cable B

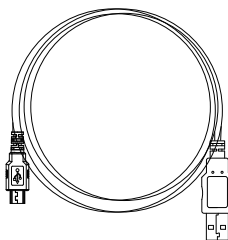

6 Micro-USB

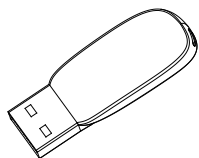

7 USB Flash Drive

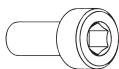

8 M3X12\*2

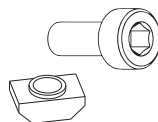

9 M4X8\*2  
M4 nut\*2

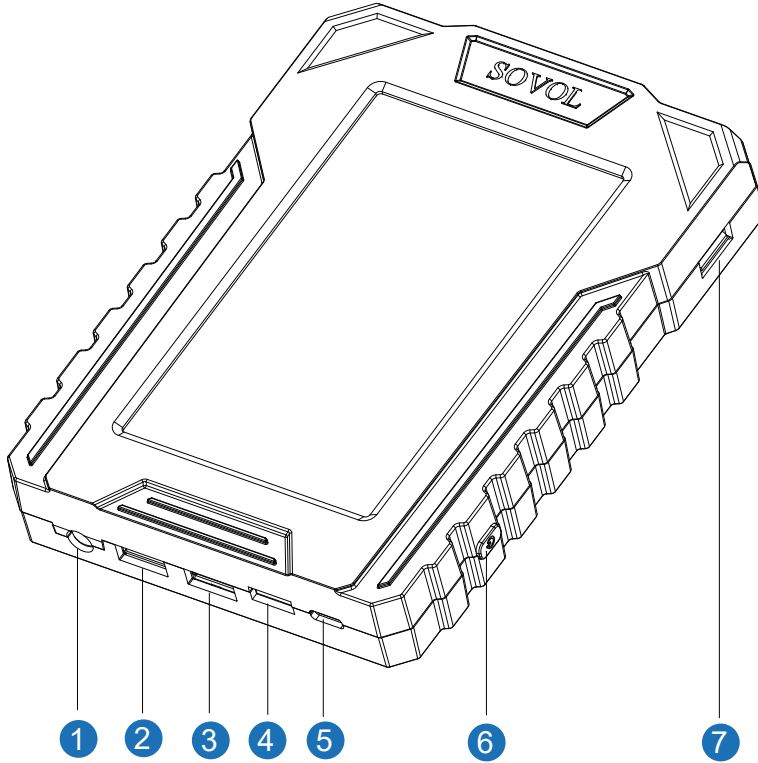

- ① DC12~24V
- ② USB2.0
- ③ USB3.0
- ④ Accelerometer
- ⑤ Type-C
- ⑥ Power
- ⑦ USB2.0

Accelerometer pin definition:



- ⑥ **Power:** ● Press the Power button for more than 5s at power on status, the klipper system will closed.
- Press the Power button for 1s at power off status, it will power on.

★ After closing the klipper system, the printing will be stopped, even though you didn't turn off the machine's power.

1

Remove the display from the bracket on the right side of the base.

2

Press diagonally upward to get it out of the holder.

1

Please unplug the power cable

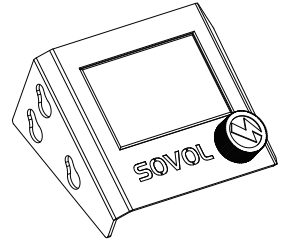

Display

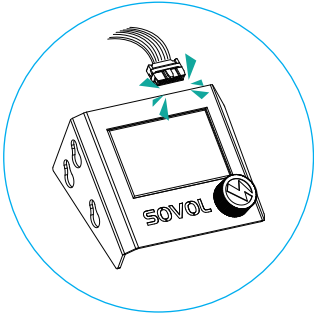

Remove screen cable

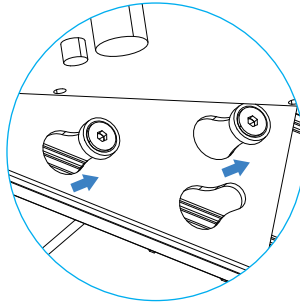

Remove screen

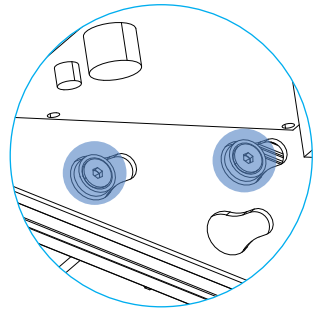

2

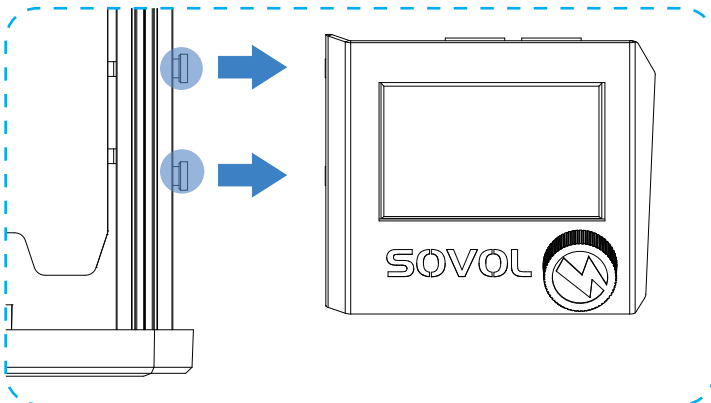



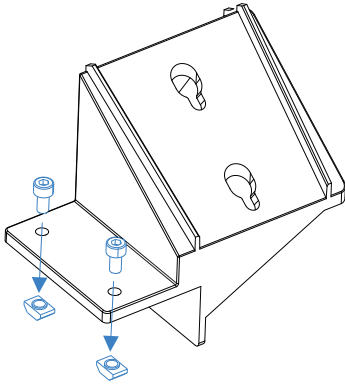

1

Fixing the mounting bracket to the profile with two **M4X8** screws and **M4** nuts

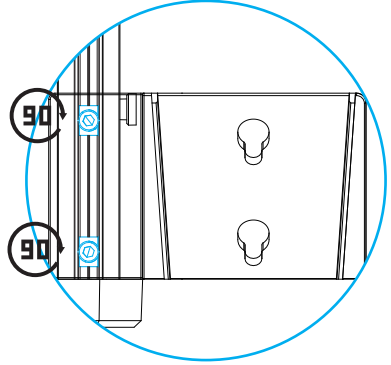

2

Rotate the nut by 90° and snap it into the profile, then use a screwdriver to fasten the screw.

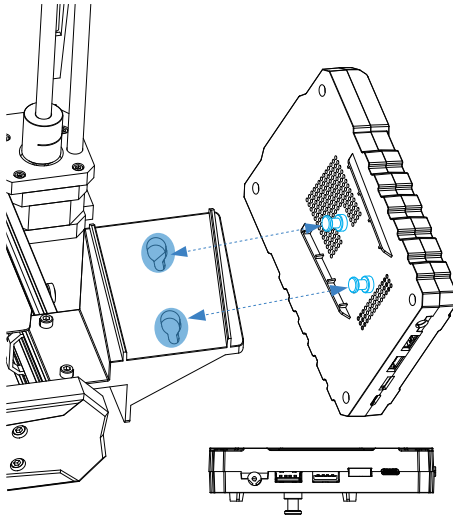

The ports are on the bottom

3

Install the touchscreen on the bracket.

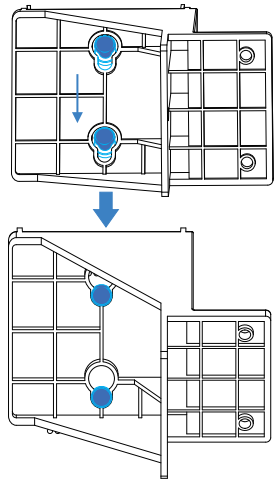

4

Slide the touchscreen downwards to attach it to the bracket.

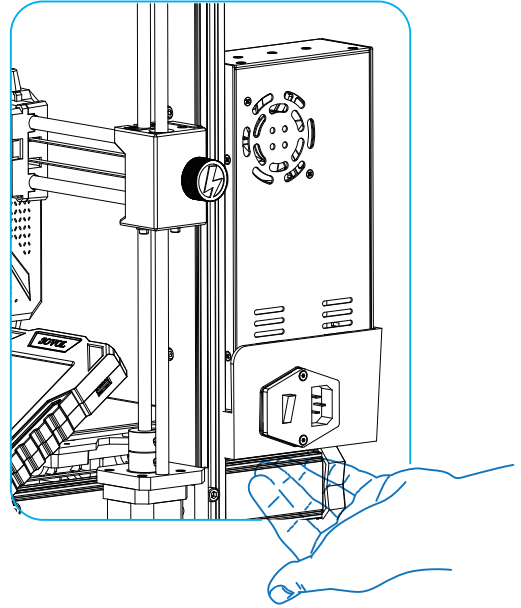
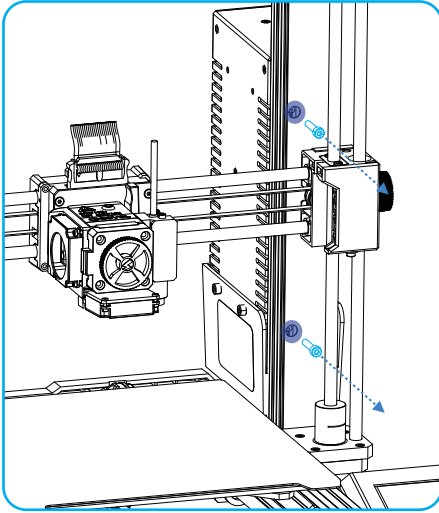

- 1 Unscrew the M4X20 screws from the gantry profile

- 2 Be careful to hold the power supply with your hand to prevent it from falling down

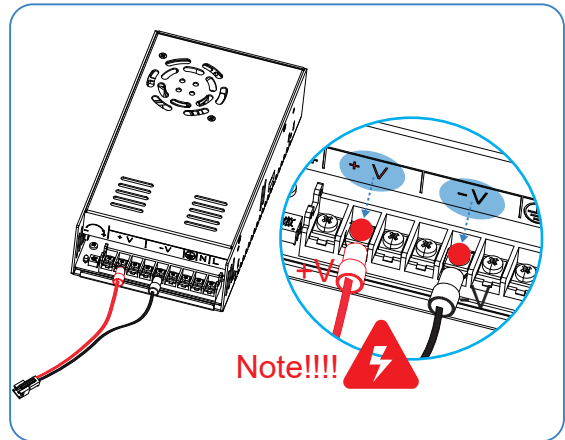
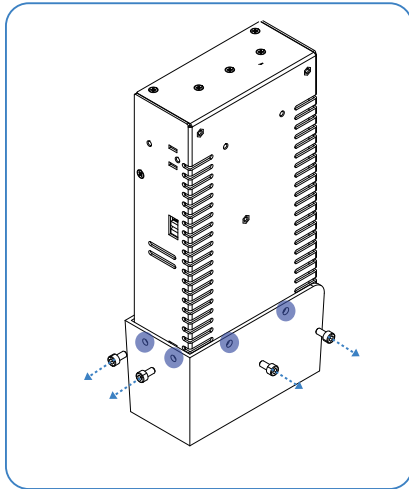

- 3 Remove the 4 screws from the power supply case

- 4 Connect the red and black wires to the corresponding locations on the power supply

1

Connecting the Micro USB cable

2

Connecting the Display Power Cord

3

Connect the micro usb cable and display power cable to the corresponding ports on the display

Micro USB cable

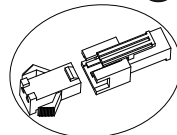
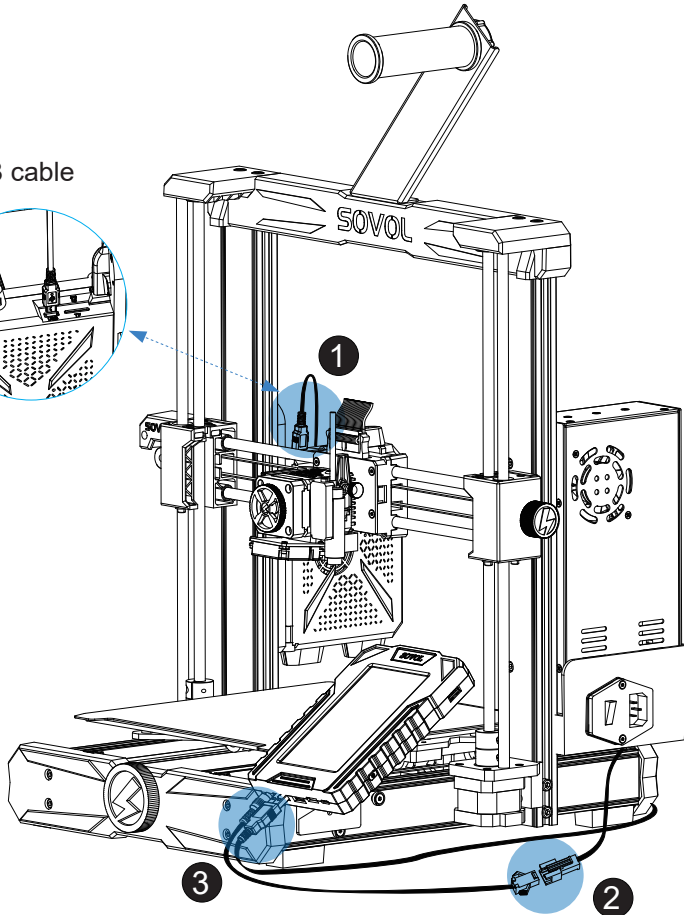
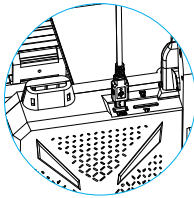

Screen power cable

- 1 Copying files "SV06 firmware.bin" from USB flash drive to TF card
- 2 Turn on the power
- 3 Wait about 1 minute to refresh the firmware

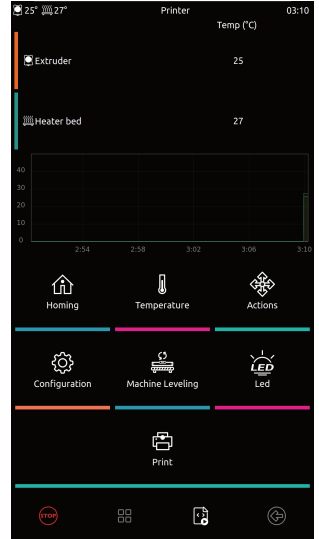
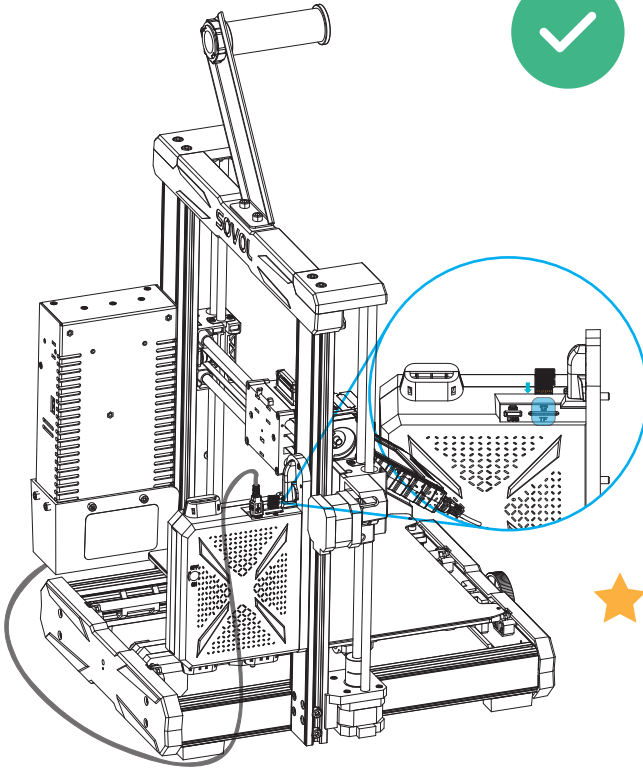
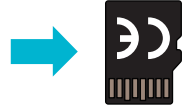

★ Enter the main interface and refresh successfully

- ★ The accelerometer is an optional module, you can choose whether to install it according to your needs.

To measure the X-axis acceleration, the following is the installation position of the accelerometer.

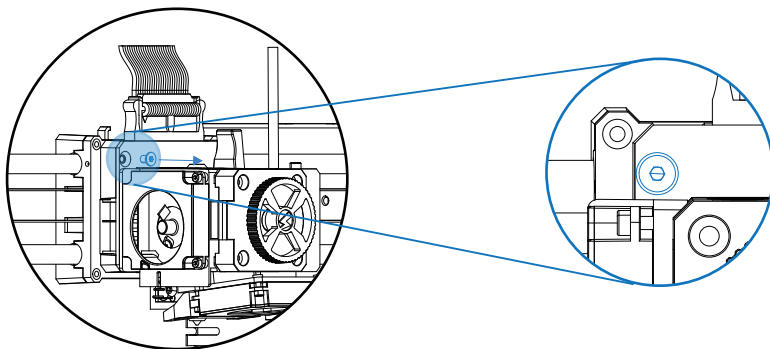

1

Remove the **M3** screw on the left side of the mounting plate

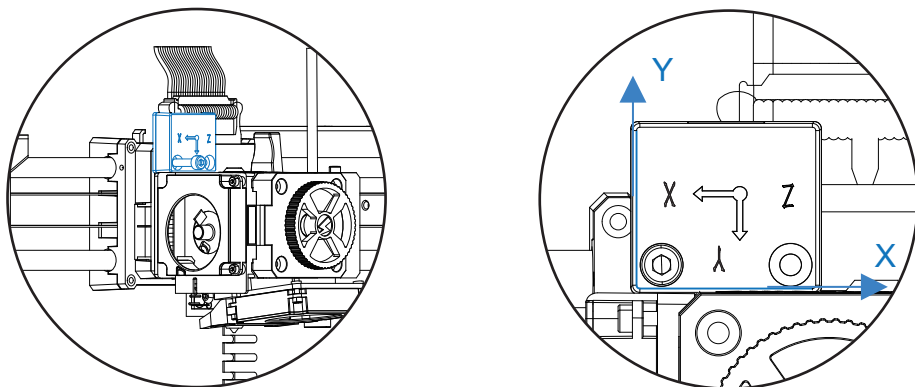

2

Mount the accelerometer using a **M3X12** screws as shown.

- ★ Please note that the direction of the acceleration should not be reversed. Refer to the direction indicated by the XY coordinate axis as shown. The accelerometer should be installed squarely, flush with the sides of the nozzle, not skewed.

- ★ The accelerometer is an optional module, you can choose whether to install it according to your needs.

To measure the Y-axis acceleration, the following is the installation position of the accelerometer.

### SV06

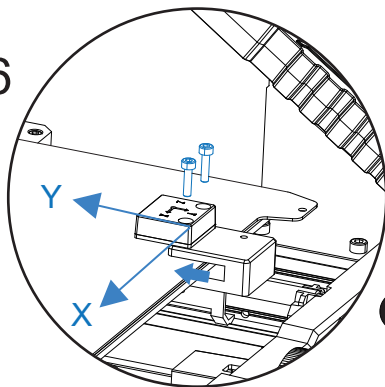

- 1 Y Acceleration bracket downloads and prints from a USB flash drive ★
- 2 Mount the acceleration sensor on the bracket using the M3X12 screws, paying attention to the X/Y direction
- 3 Acceleration sensor mounted on the right side ★

### SV06 Plus

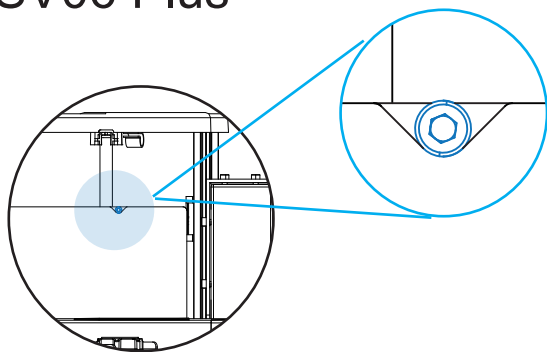

- 1 Remove the M3X5 screw from the upper right corner of the heat bed

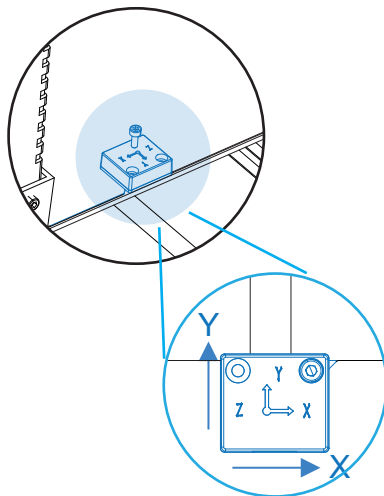

- 2 Secure the acceleration sensor to the hot bed plate using M3X12 screws

- ★ Pay attention to the direction of mounting 

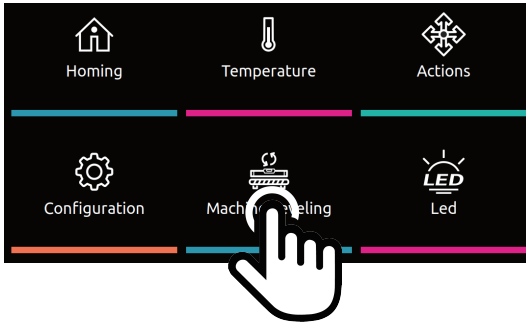

1. After finish adjustment, Click \*Machine leveling\* on the home page.

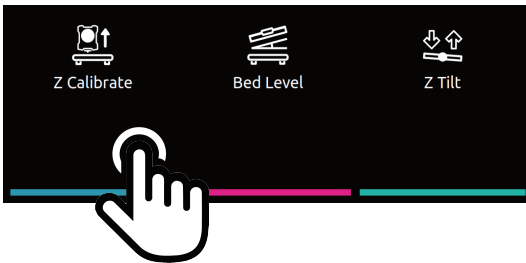

2. Click \* Z calibrate\*.

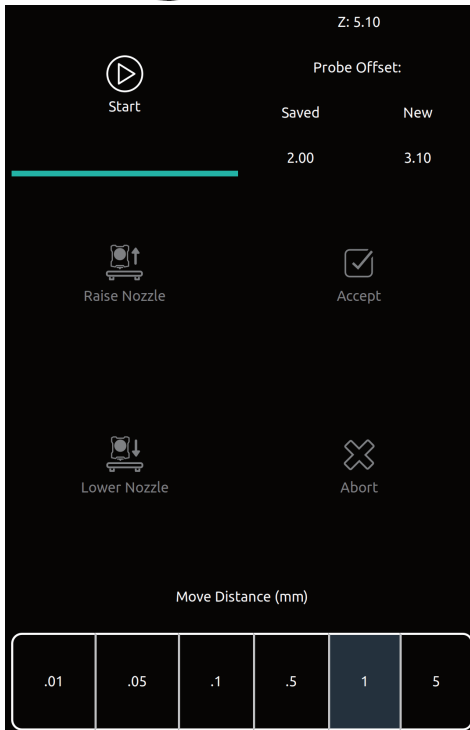

★ Please do not move a large distance at one time to avoid the nozzle hitting the hotbed.

1. Click \*start\*, the printer will auto home first.
2. After the printer auto home, the nozzle will slowly move to the center of the bed, put a piece of A4 paper between the nozzle and the hotbed.
3. Select the suitable move distance then click \*raise nozzle\* or \*lower nozzle\*, to adjust the distance between the nozzle and the hotbed.
4. Adjust the distance between the nozzle and the hotbed (please keep pulling the paper during the period, when you feel resistance to pulling the paper and the nozzle does not completely press the paper, the distance is appropriate).
5. Click \*accept\* to apply the values, then confirm and restart the system.

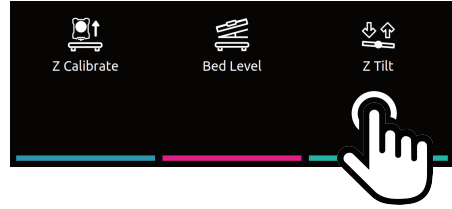
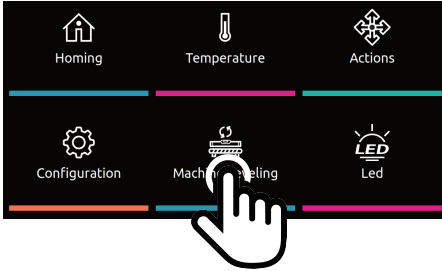

2. Click \* Z Tilt\*.

1. After finish adjustment, Click \*Machine leveling\* on the home page.

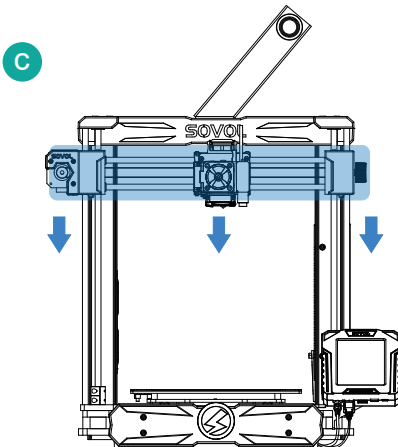
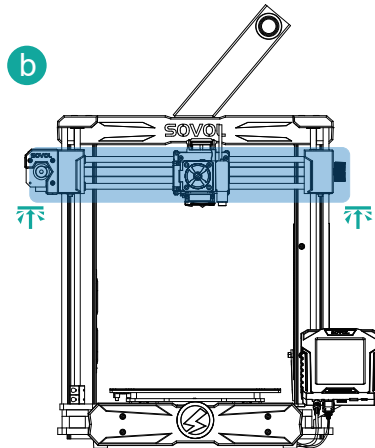
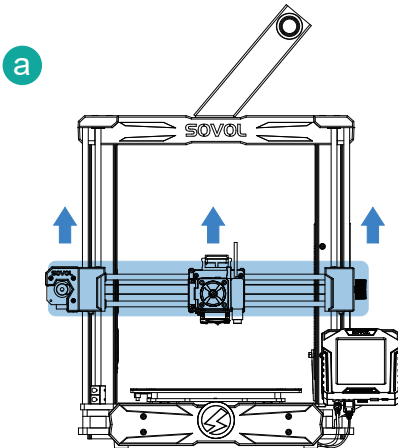

The machine will auto-home first, then the entire X-axis will rise to the top for calibration, then descend to auto-home.



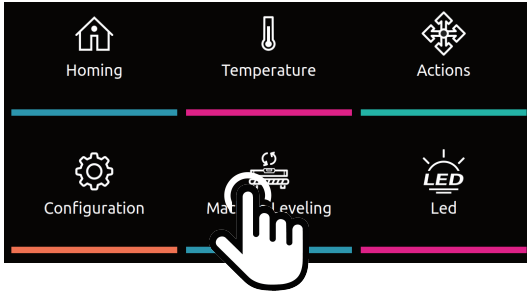

1. Click \* Machine Leveling \*

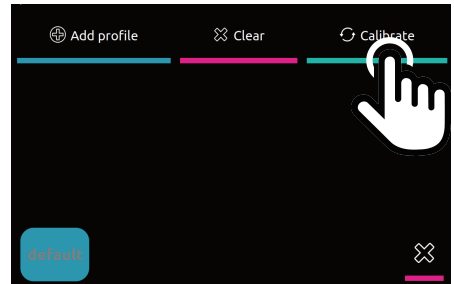
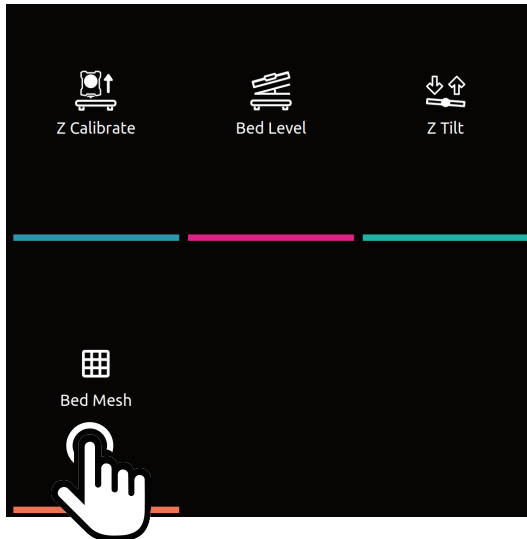

2. Click \*Bed Mesh\*, then click \*Calibrate\* after the detection is complete, restart the system Leveling complete.

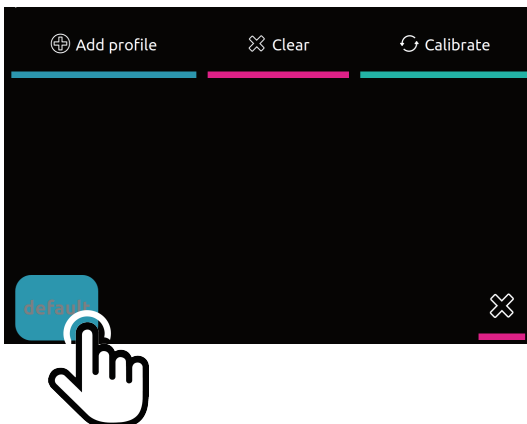

★ If you want to view the bed mesh data later, please return to this interface and click the current configuration name "default" to view

Add profile		Clear		Calibrate	
0.11	0.08	0.05	0.02	-0.04	
0.07	0.06	0.04	0.02	-0.03	
-0.01	0.00	0.00	0.00	-0.03	
-0.10	-0.05	-0.04	-0.04	-0.06	
-0.14	-0.11	-0.10	-0.12	-0.14	

default

1. The data of the bed reflects whether the bed is leveled. The detection data divides the hotbed into 25 small areas to detect the unevenness. When 0 means flat, the positive value means relatively high, and the negative value means relatively low. The machine will compensate these difference by the offset value between the nozzle and the hotbed according those data.

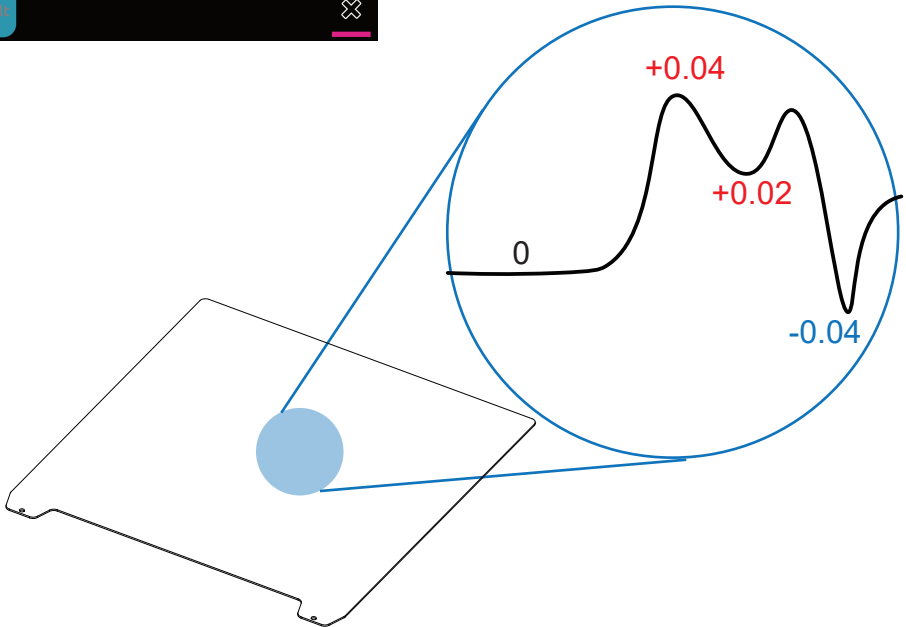

**1** Double-click to install Sovol-Cura in the TF card file



Sovol3D\_Cura-5.0.0-win64

**2** Select to add SV06 (Klipper) or SV06PLUS (Klipper)

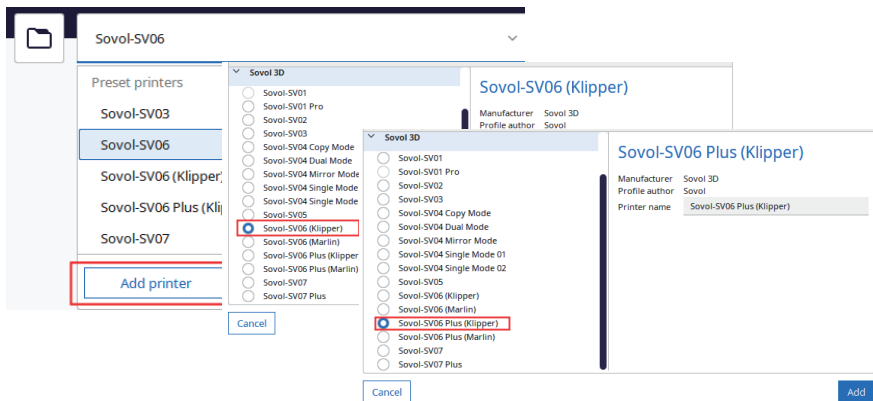

**3** Slice and save the file to USB flash drive

**a**

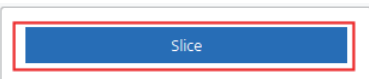

**b**

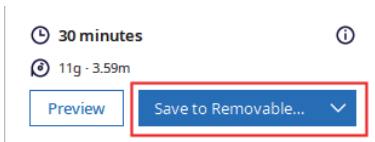

**c**

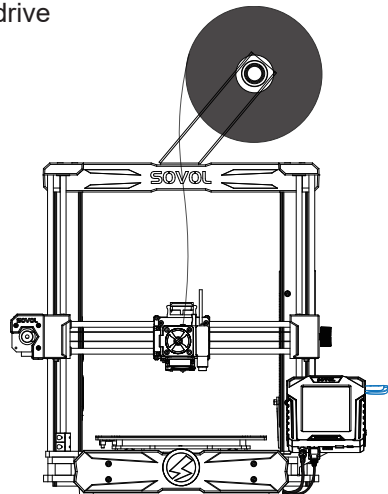
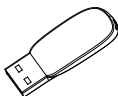



Sovol Support Group



sovol3d.com

SHENZHEN Lian Dian Chuang Technology CO.,LTD.

Official website: [sovol3d.com](http://sovol3d.com)

Email: [info@sovol3d.com](mailto:info@sovol3d.com)

